



Monday, June 4, 2018
PLAN OF THE DAY (PoD)

Hilltopper Wind Farm
74 WTG's
GE 2.50 MW
185 MW Capacity



Substantial Completion	Wednesday, October 31, 2018
COD	Saturday, December 1, 2018

TODAY'S WEATHER FORECAST

Conditions	Sunny	Wind Direction	SSW	Wind Speed	5-10 mph	Dew Point	68%	Temperature	87 °F	67 °F	Humidity	57%	Precipitation	50%
------------	-------	----------------	-----	------------	----------	-----------	-----	-------------	-------	-------	----------	-----	---------------	-----

DAILY ROAD CLOSURES/BLOCKAGES

Please help keep our guys safe and watch speeds in marked construction areas.

05JUNE18 Road Closures/Blockages

Road Closure for Culvert Replacements will be #17-#16 on C.H. 12 (950th) from 1000th to 1175th;
Road Closure for Culvert Replacements will be #54 on 1150th from 700th to 800th

06JUNE18 Road Closures/Blockages

Road Closure for Culvert Replacements will be #17-#16 on C.H. 12 (950th) from 1000th to 1175th;
Road Closure for Culvert Replacements will be #62 on 1150th from 800th to 950th.

07JUNE18 Road Closures/Blockages

Road Closure for Culvert Replacements will be #17-#16 on C.H. 12 (950th) from 1000th to 1175th;
Road Closure for Culvert Replacements will be #48 & #45 on 1075th from 950th to 800th.

Extended Road Closure Notice

Extended Road Closure for Culvert Replacements will be #17-#16 on C.H. 12 (950th) from 1000th to 1175th. This closure will take place from 6/4/2018 to 6/7/2018.

Extended Road Closure for Culvert Replacements will be #17-#16 on C.H. 12 (950th) from 1000th to 1175th. This closure will take place from 6/4/2018 to 6/7/2018.

Road Closure for Culvert Replacements will be #48 & #45 on 1075th from 950th to 800th.

Road Closure for Culvert Replacements will be #62 on 1150th from 800th to 950th.

Road Closure for Culvert Replacements will be #54 on 1150th from 700th to 800th

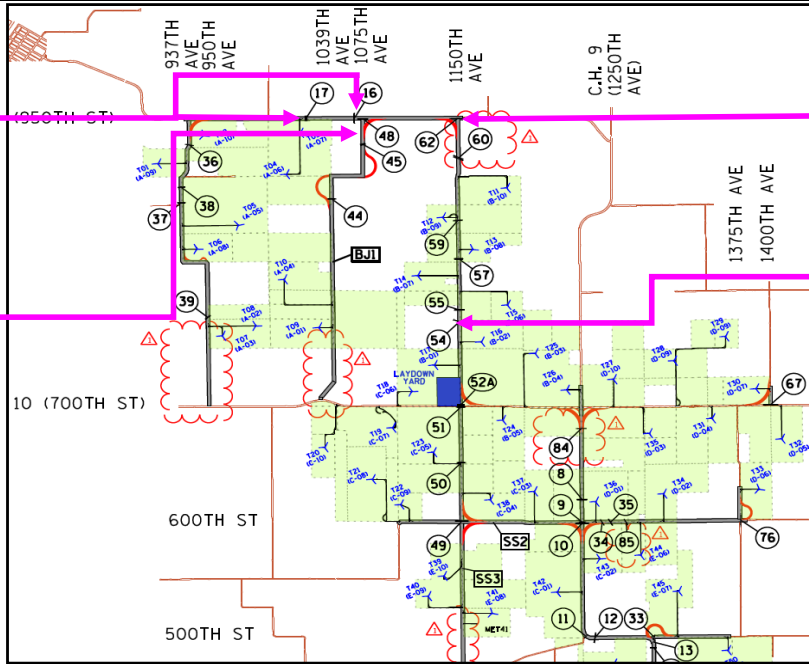

Tuesday: Tuesday Road Closure for Culvert Replacements will be #17-#16 on C.H. 12 (950th) from 1000th to 1175th. This closure will take place from 6/4/2018 to 6/7/2018; Tuesday Road Closure for Culvert Replacements will be #51 on 1150th from 700th to 600th.
Wednesday: Wednesday Road Closure for Culvert Replacements will be #54-#55 on 1150th from 700th to 800th.
Thursday: Thursday Road Closure for Culvert Replacements will be #57-#59 on 1150th from 800th to 950th.

Please contact the following people if there are any questions.
Daniel Sheehan - dsheehan@swiftcurrentenergy.com
Antonio Bombaci - antonio.bombaci@enel.com