



Thursday, June 7, 2018
PLAN OF THE DAY (PoD)

Hilltopper Wind Farm
74 WTG's
GE 2.50 MW
185 MW Capacity



Substantial Completion	Wednesday, October 31, 2018
COD	Saturday, December 1, 2018

TODAY'S WEATHER FORECAST

Conditions	Partly Cloudy	Wind Direction	SW	Wind Speed	5-10 mph	Dew Point	64%	Temperature	93 °F	69 °F	Humidity	77%	Precipitation	20%
------------	---------------	----------------	----	------------	----------	-----------	-----	-------------	-------	-------	----------	-----	---------------	-----

DAILY ROAD CLOSURES/BLOCKAGES

Please help keep our guys safe and watch speeds in marked construction areas.

Thursday - 07JUNE18 Road Closures/Blockages

Road Closure for Culvert Replacements will be #17-#16 on C.H. 12 (950th) from 1000th to 1175th;
Road Closure for Culvert Replacements will be #76 on 600th from 1375th to 1500th;
Thursday Road Closure for Culvert Replacements will be #49 on 1150th from 600th to 700th (1/2 day remaining).

Friday - 08JUNE18 Road Closures/Blockages

Road Closure for Culvert Replacements will be #39 on 950th from CH 10 (700th St.) to CH 12 (950th St.).
Road Closure for Culvert Replacements will be #76 on 600th from 1375th to 1500th.

Saturday - 09JUNE18 Road Closures/Blockages

Road Closure for Culvert Replacements will be #39 on 950th from CH 10 (700th St.) to CH 12 (950th St.).
Road Closure for Culvert Replacements will #67 on 1400th from 700th - 800th.

Extended Road Closure for Culvert Replacements will be #17-#16 on C.H. 12 (950th) from 1000th to 1175th. This closure will take place from 6/4/2018 to 6/7/2018.

Extended Road Closure Notice

Extended Road Closure for Culvert Replacements will be #76 on 600th from 1375th to 1500th. This Road Closure will be from Thursday 6/7 to Friday 6/8

Extended Road Closure for Friday for Culvert Replacements will be #39 on 950th from CH 10 (700th St.) to CH 12 (950th St.). This Road Closure will be from Friday 6/8 to Tuesday 6/12.

Extended Road Closure for Culvert Replacements will be #17-#16 on C.H. 12 (950th) from 1000th to 1175th. This closure will take place from 6/4/2018 to 6/7/2018.

Road Closure for Culvert Replacements will be #39 on 950th from CH 10 (700th St.) to CH 12 (950th St.).

Road Closure for Culvert Replacements will #67 on 1400th from 700th - 800th.

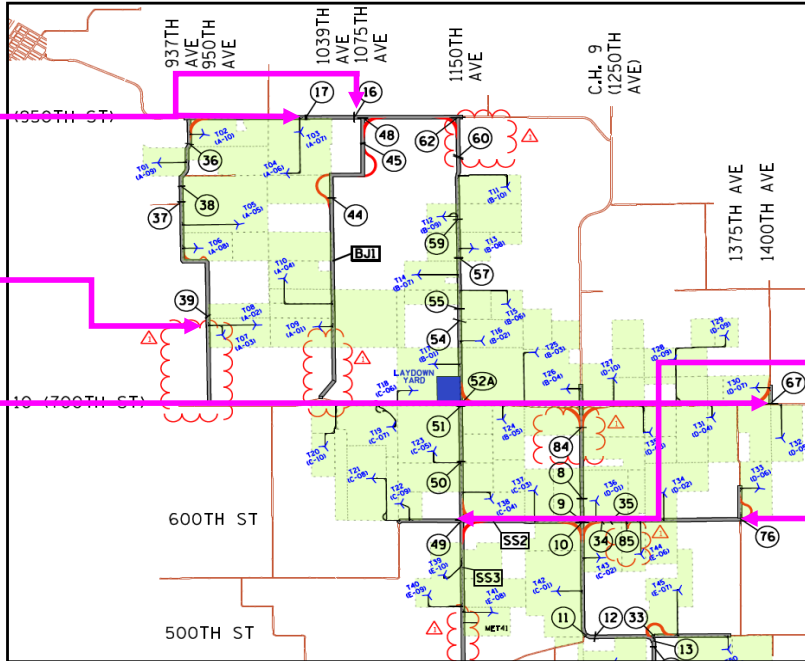

Road Closure for Culvert Replacements will be #49 on 1150th from 600th to 700th.

Road Closure for Culvert Replacements will be #76 on 600th from 1375th to 1500th. This road closure will be from Thursday 6/7 to Friday 6/8.

Thursday:
Extended Thursday Road Closure for Culvert Replacements will be #17-#16 on C.H. 12 (950th) from 1000th to 1175th. This closure will take place from 6/5/2018 to 6/7/2018.

Thursday Road Closure for Culvert Replacements will be #49 on 1150th from 600th to 700th (1/2 day remaining).

Extended Road Closure for Thursday for Culvert Replacements will be #76 on 600th from 1375th to 1500th.
This Road Closure will be from Thursday 6/7 to Friday 6/8.

Friday:
Extended Road Closure for Friday for Culvert Replacements will be #39 on 950th from CH 10 (700th St.) to CH 12 (950th St.).
This Road Closure will be from Friday 6/8 to Tuesday 6/12.

Saturday:
Saturday Road Closure for Culvert Replacements will #67 on 1400th from 700th - 800th.

Please contact the following people if there are any questions.
Daniel Sheehan - dsheehan@swiftcurrentenergy.com
Antonio Bombaci - antonio.bombaci@enel.com