



Wednesday, July 11, 2018
PLAN OF THE DAY (PoD)

HillTopper Wind Farm
74 WTC's
GE 2.50 MW
185 MW Capacity



Substantial Completion	Wednesday, October 31, 2018
COD	Saturday, December 1, 2018

TODAY'S WEATHER FORECAST

Conditions	Sunny	Wind Direction	ENE	Wind Speed	5-10 mph	Dew Point	42%	Temperature	82 °F	54 °F	Humidity	60%	Precipitation	10%
------------	-------	----------------	-----	------------	----------	-----------	-----	-------------	-------	-------	----------	-----	---------------	-----

DAILY ROAD CLOSURES/BLOCKAGES

Please help keep our guys safe and watch speeds in marked construction areas.

Wednesday - 11JUL18 Road Closures/Blockages	Road Closure For Crane Crossing will be at Crossing Location #10 on 1400th from IL 54 to 400th. This Closure Will Take Place From 8:00am until 12:00pm.
Thursday - 12JUL18 Road Closures/Blockages	Extended Road Closure For Cement Stabilization will be on 300th from 1500th to 1600th.
Friday - 13JUL18 Road Closures/Blockages	Road Closure For Cement Stabilization will be on 300th from 1500th to 1600th. Road Closure will be on 1500th from 400th to 275th.
Extended Road Closure Notice	Extended Road Closure For Asphalt at Railroad Intersection will be on CH 9 from IL 54 to 500th. This Road Closure will Extend from Wednesday, 7/18 through Saturday, 7/21. Extended Road Closure For Cement Stabilization will be on 300th from 1500th to 1600th. This Road Closure will Extend Through Friday, 7/20. Extended Road Closure will be on 1500th from 400th to 275th. This Road Closure will Extend Through Wednesday, 7/18.

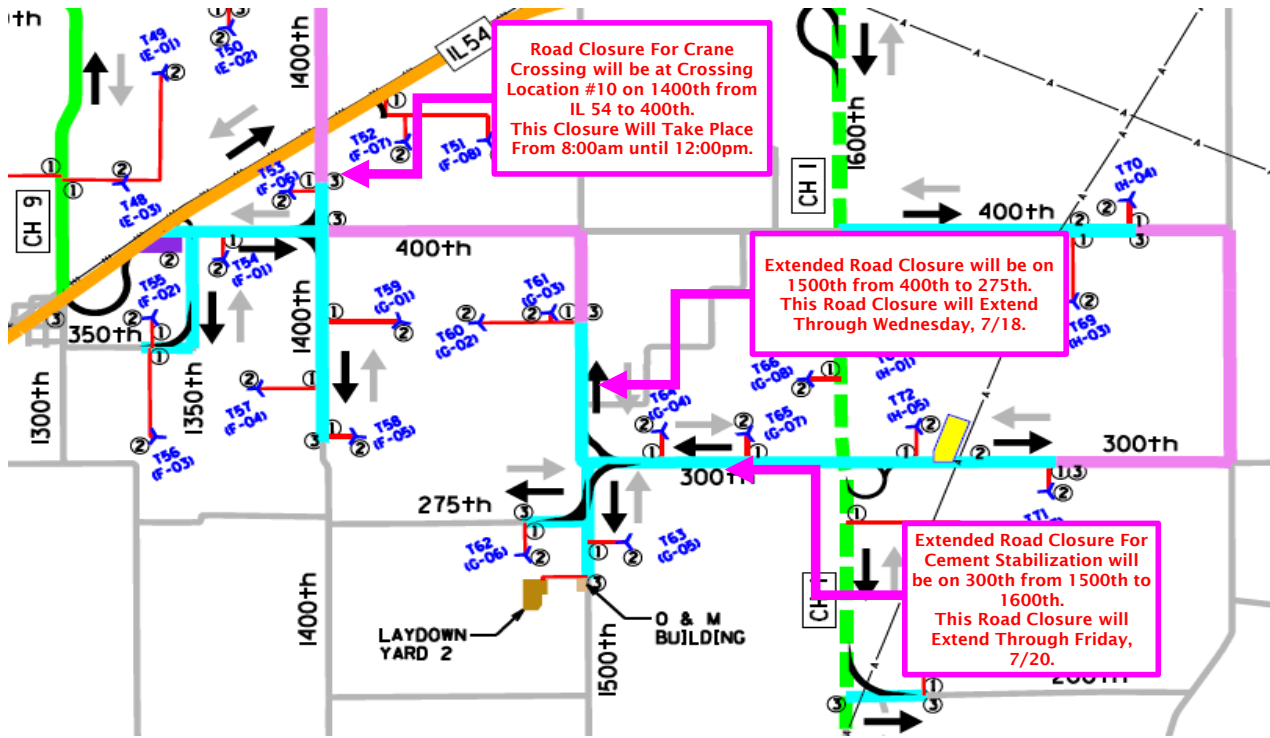

Wednesday 7/11
Road Closure For Crane Crossing will be at Crossing Location #10 on 1400th from IL 54 to 400th. This Closure Will Take Place From 8:00am until 12:00pm.

Thursday 7/12
Extended Road Closure For Cement Stabilization will be on 300th from 1500th to 1600th. This Road Closure will Extend Through Friday, 7/20.

Friday 7/13
Extended Road Closure will be on 1500th from 400th to 275th. This Road Closure will Extend Through Wednesday, 7/18.

Wednesday 7/18
Extended Road Closure For Asphalt at Railroad Intersection will be on CH 9 from IL 54 to 500th. This Road Closure will Extend Through Saturday, 7/21.

Please contact the following people if there are any questions.
Daniel Sheehan - dsheehan@swiftcurrentenergy.com
Antonio Bombaci - antonio.bombaci@enel.com
Moris Schiavoni - moris.schiavoni@enel.com