



Friday, July 13, 2018
PLAN OF THE DAY (PoD)

HillTopper Wind Farm
 74 WTC's
 GE 2.50 MW
185 MW Capacity



Substantial Completion	Wednesday, October 31, 2018
COD	Saturday, December 1, 2018

TODAY'S WEATHER FORECAST

Conditions	Sunny	Wind Direction	ENE	Wind Speed	5-10 mph	Dew Point	42%	Temperature	82 °F	54 °F	Humidity	60%	Precipitation	10%
------------	-------	----------------	-----	------------	----------	-----------	-----	-------------	-------	-------	----------	-----	---------------	-----

DAILY ROAD CLOSURES/BLOCKAGES

Please help keep our guys safe and watch speeds in marked construction areas.

Thursday - 12JUL18 Road Closures/Blockages Road Closure for Paving on CH-09 from IL54 to just north of CH-10

Friday - 13JUL18 Road Closures/Blockages Road Closure For Cement Stabilization will be on 300th from 1500th to 1600th.
 Road Closure will be on 1400th from 400th to 275th for a Jump Bridge Install.
 Road Closure for Paving on CH-09 from IL54 to just north of CH-10

Saturday - 14JUL18 Road Closures/Blockages Road Closure For Cement Stabilization will be on 300th from 1500th to 1600th.
 Road Closure will be on 1400th from 400th to 275th for a Jump Bridge Install.
 Road Closure for Paving on CH-09 from IL54 to just north of CH-10

Sunday - 15JUL18 Road Closures/Blockages Road Closure For Cement Stabilization will be on 300th from 1500th to 1600th.
 Road Closure will be on 1400th from 400th to 275th for a Jump Bridge Install.
 Road Closure for Paving on CH-09 from IL54 to just north of CH-10

Monday - 16JUL18 Road Closures/Blockages Road Closure For Cement Stabilization will be on 300th from 1500th to 1600th.
 Road Closure will be on 1400th from 400th to 275th for a Jump Bridge Install.
 Road Closure for Paving on CH-09 from IL54 to just north of CH-10

Extended Road Closure for Paving on CH-09 from IL54 to just north of CH-10.
 This road closure will extend from Wednesday, 7/11 through Tuesday, 7/24.

[Extended Road Closure Notice](#)

Extended Road Closure For Asphalt at Railroad Intersection will be on CH 9 from IL 54 to 500th.
 This Road Closure will Extend from Wednesday, 7/18 through Saturday, 7/21.

Extended Road Closure For Cement Stabilization will be on 300th from 1500th to 1600th.
 This Road Closure will Extend Through Friday, 7/20.

Road Closure will be on 1400th from 400th to 275th for a Jump Bridge Install.
 This Road Closure will Extend Through Wednesday, 7/18.

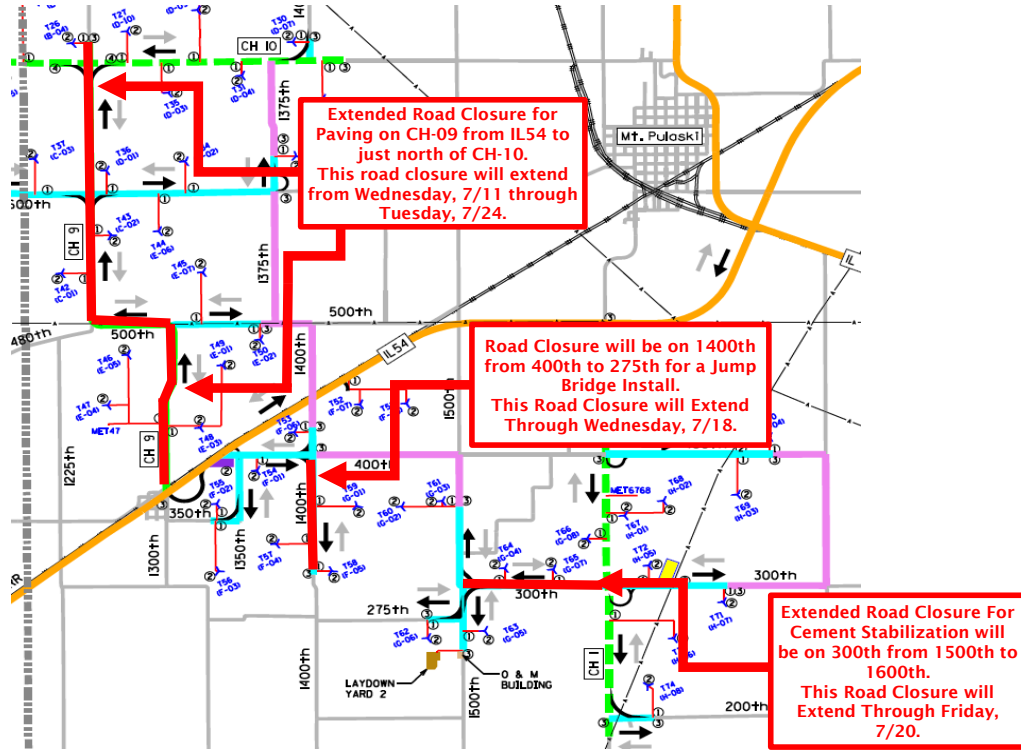

Thursday 7/12
 Extended Road Closure For Cement Stabilization will be on 300th from 1500th to 1600th.
 This Road Closure will Extend Through Friday, 7/20.

Friday 7/13
 Extended Road Closure will be on 1500th from 400th to 275th.
 This Road Closure will Extend Through Wednesday, 7/18.

Wednesday 7/18
 Extended Road Closure For Asphalt at Railroad Intersection will be on CH 9 from IL 54 to 500th.
 This Road Closure will Extend Through Saturday, 7/21.

Please contact the following people if there are any questions.
 Daniel Sheehan - dsheehan@swiftcurrentenergy.com
 Antonio Bombaci - antonio.bombaci@enel.com
 Moris Schiavoni - moris.schiavoni@enel.com