



**Saturday, July 14, 2018**  
PLAN OF THE DAY (PoD)

**HillTopper Wind Farm**  
74 WTC's  
GE 2.50 MW  
185 MW Capacity



Substantial Completion	Wednesday, October 31, 2018
COD	Saturday, December 1, 2018

**TODAY'S WEATHER FORECAST**

Conditions	Sunny	Wind Direction	ENE	Wind Speed	5-10 mph	Dew Point	42%	Temperature	90 °F	70 °F	Humidity	60%	Precipitation	0%
------------	-------	----------------	-----	------------	----------	-----------	-----	-------------	-------	-------	----------	-----	---------------	----

**DAILY ROAD CLOSURES/BLOCKAGES**

**Please help keep our guys safe and watch speeds in marked construction areas.**

<b>Saturday - 14JUL18 Road Closures/Blockages</b>	Road Closure will be on 1400th from 400th to 275th for a Jump Bridge Install. Road Closure for Paving on CH-09 from IL54 to just north of CH-10
<b>Sunday - 15JUL18 Road Closures/Blockages</b>	Road Closure will be on 1400th from 400th to 275th for a Jump Bridge Install. Road Closure for Paving on CH-09 from IL54 to just north of CH-10
<b>Monday - 16JUL18 Road Closures/Blockages</b>	Road Closure will be on 1400th from 400th to 275th for a Jump Bridge Install. Road Closure for Paving on CH-09 from IL54 to just north of CH-10
<b>Tuesday - 17JUL18 Road Closures/Blockages</b>	Road Closure For Cement Stabilization will be on 300th from 1500th to 1600th. Road Closure will be on 1400th from 400th to 275th for a Jump Bridge Install. Road Closure for Paving on CH-09 from IL54 to just north of CH-10
<b>Wednesday - 18JUL18 Road Closures/Blockages</b>	Road Closure For Cement Stabilization will be on 300th from 1500th to 1600th. Road Closure will be on 1400th from 400th to 275th for a Jump Bridge Install. Road Closure For Asphalt at Railroad Intersection will be on CH 9 from IL 54 to 500th.

**Extended Road Closure for Paving on CH-09 from IL54 to just north of CH-10.**  
This road closure will extend from Wednesday, 7/11 through Tuesday, 7/24.

Extended Road Closure For Asphalt at Railroad Intersection will be on CH 9 from IL 54 to 500th.  
This Road Closure will Extend from Wednesday, 7/18 through Saturday, 7/21.

Extended Road Closure For Cement Stabilization will be on 300th from 1500th to 1600th.  
This Road Closure will Extend Through Wednesday, 7/25.

Road Closure will be on 1400th from 400th to 275th for a Jump Bridge Install.  
This Road Closure will Extend Through Wednesday, 7/18.

[Extended Road Closure Notice](#)

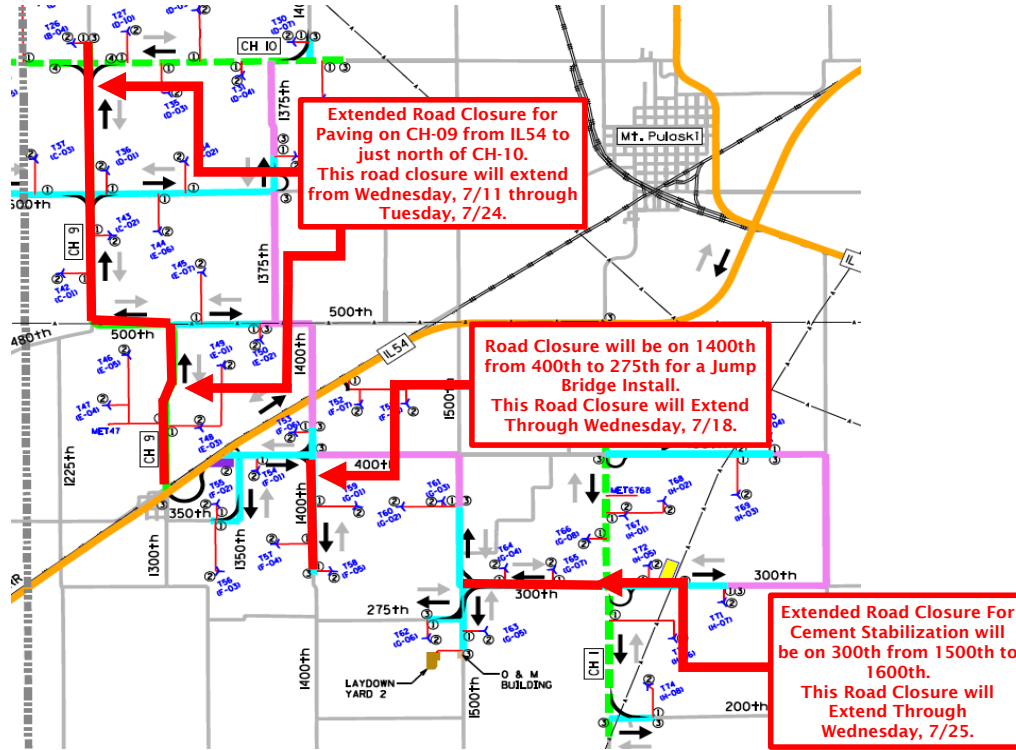

**Saturday 7/14**  
Extended Road Closure will be on 1400th from 400th to 275th.  
This Road Closure will Extend Through Wednesday, 7/18.

**Tuesday 7/17**  
Extended Road Closure will be on 300th from 1500th to 1600th.  
This Road Closure will Extend Through Wednesday, 7/25.

**Wednesday 7/18**  
Extended Road Closure For Asphalt at Railroad Intersection will be on CH 9 from IL 54 to 500th.  
This Road Closure will Extend Through Saturday, 7/21.

**Please contact the following people if there are any questions.**  
Daniel Sheehan - dsheehan@swiftcurrentenergy.com  
Antonio Bombaci - antonio.bombaci@enel.com  
Moris Schiavoni - moris.schiavoni@enel.com